

Flanged Immersion

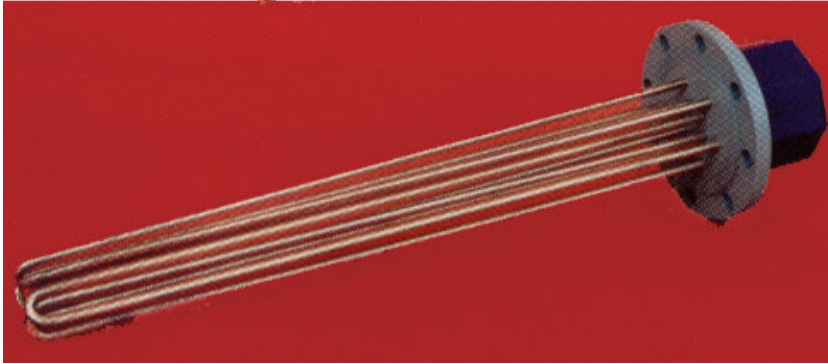

CONSTRUCTION:

1. Terminal housing, NEMA 1 general purpose, for electrical connections.
2. Standard pipe flange. 3"-12" Steel or S.S.
3. Tubular heating element

FEATURES:

- 150# rating ANSI carbon steel flange – 300# available
- Steel, stainless steel, copper, or incoloy sheathed elements.
- Optional thermostat and well for temperature control.
- Element supports in multiple element units for proper element spacing as required.
- General-purpose terminal housing available for special applications.

Clean Water
Process Water or Very Mild Solutions
Mild solutions
Demineralized or Deionized Water
Low Viscosity Oil
Medium Viscosity Oil
High Viscosity Oil
Small Tanks
Process Water Demineralized Water Low Viscosity Oil
Pipe Insert
Hot Tubs, Spa
Commercial Equipment

FLANGE STYLES:

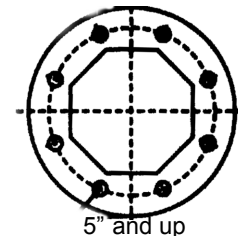
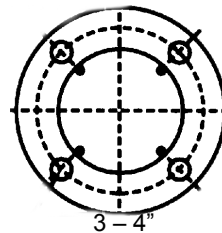
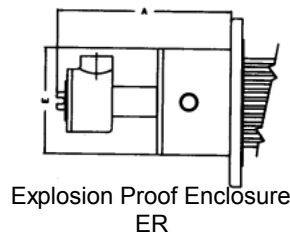
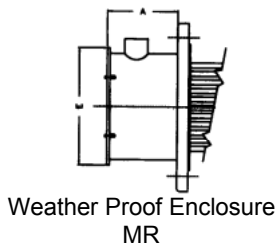

For Weather Proof Enclosure add suffix "MR" to catalogue number
For Explosion Proof Enclosure add suffix "ER" to catalogue number

WEST HEAT INDUSTRIES LTD

1680 Church Avenue
Winnipeg, Manitoba R2X 2W9
www.westheat.com

ELECTRICAL HEATING DIVISION

Phone: (204) 694-2129
Fax: (204) 694-2098
Fax Orders To: 1-800 358-7711